

项目	数量	零件号	中文名称	英文名称	说明
1	1	Y03101	铝合金底盘	Chassis Aluminum	
2	1	Y03102	皮带盖	Strap Cover	
3	1	Y03103	覆盖底板	Back Cover Board	
4	1	Y03104	水接口	Clean coupler	
5	1	Y03105	塑料螺母	Plastic nut	
6	2	Y03115	前支架压板	Front bracket fixing board	
7	2	Y03116	后支架压板	Back bracket fixing board	
8	1	Y01106-L	扶手支架 L	Handle Bracket L	
9	1	Y01106-R	扶手支架 R	Handle Bracket R	
10	1	Y03118	防护板	Protection plank	
11	1	Y03119	O型圈	O type turn	
12	13	GB5789-86-M5x12	六角法兰螺栓	Bolt	
13	4	GB5789-86-M8x16	六角法兰螺栓	Bolt	
14	6	GB6182-M8	六角螺母	Nut	
15	2	GB6561-86-ST48-12	自攻螺钉	From offend bolt	
16	1	Y01108	防护罩	Shield	
17	1	Y01109	防护罩轴	Shield Shaft	
18	2	Y03112	下扶手	Lower Handle	
19	2	Y03114	内嵌转齿盘	Inner ratchet clamp	
20	1	Y03117	上扶手	Upper Handle	
21	1	Y01113-2	熄火开关	Stop Switch	
22	1	Y01114-2	自走开关	Drive Switch	
23	1	Y01115-2	软扶手套	Foam Glove	
24	2	Y01120	装饰盖	Decorate Cover	
25	1	Y01123	草盖扣簧	Spring for Flap	
26	2	Y01124	间距衬套	Space Bush	
27	1	Y01125	覆盖板	Cover Board	
28	1	Y01128	排扣	Rope Guide	
29	1	Y02321	自走拉线	Drive cable	
30	1	Y01130	调高拉簧	Spring	
31	1	Y01131	档位板	Ward Board	
32	1	Y01132	弹簧	Spring	
33	2	Y03113	外嵌转齿盘	Outer ratchet clamp	
34	3	GB6561-86-ST4.8x12	自攻螺丝	Bolt	
35	3	GB5789-86-M8x20	六角法兰螺栓	Bolt	
36	1	GB6170A-M6	六角螺母	Nut	
37	2	GB6182-M6	六角螺母	Nut	
38	1	GB818-M6x35	螺栓	Bolt	
39	4	GB91-86-10	销	Pin	
40	8	GBT5283-85-ST3.5-9.5	自攻螺钉	From offend bolt	
41	1	Y01201	刀片支架	Blade Bracket	
42	1	Y02202	刀片	Blade	
43	1	Y01203	刀片垫片	Washer	
44	1	Y01204	Z型V带轮	Belt Wheel	
45	1	Y01209	曲轴长键	Key	
46	1	3-8-24UNF-2B	英制六角螺栓	Bolt	
47	2	Y01205	快速扳手	Quick Fix Handle	
48	2	Y03206	扳手锁块	Lock	
49	2	Y03207	拉杆	Pull Rod	
50	2	Y01208	自锁螺母套	Locknut Cover	
51	2	GB879-86-6x20	弹性圆柱销	Pin	
52	2	GB6170-86-M8	六角薄螺母	Nut	
53	1	Y02301	齿轮箱体	Gearcase Upper	
54	1	Y02302	齿轮箱盖	Gearcase Cover	
55	1	Y02303	拨叉	Fork	
56	1	Y02304	全齿	Gear	
57	1	Y02305	锥齿	Pinion	
58	1	Y02306	驱动轴	Driver Shaft	
59	1	Y02307	衬套	Liner bushing	
60	1	Y02308	离合套	Clutch sleeve	
61	1	Y02309	拨杆	Rod	
62	1	Y02310	垫片	Washer	
63	1	Y02311	平面轴承	Plane bearing	
64	1	Y02312	复位拉簧	Spring	
65	1	Y02313	离合弹簧	Spring	
66	2	Y02314	垫片	Washer	
67	1	Y02315	拉簧	Spring	
68	1	Y02316	O形圈	O circle	
69	3	Y02317	油封	Seals	
70	1	Y02318	O形圈	O circle	
71	1	Y01308-2	V带轮	Pulley	
72	2	Y01310	传动销	Groove Pin	
73	1	Y01312	直齿L	GearL	
74	1	Y01313	直齿R	GearR	
75	2	GB894 1-86-12	轴用弹性挡圈	Washer	
76	1	6001LL-GBT276-94	深沟球轴承	Bearing	
77	1	GB879-86-4x30	弹性圆柱销	Pin	
78	1	GB8931-28	轴用弹性挡圈	Washer	
79	1	GB T8792-2000-4X16	弹性圆柱销	Pin	
80	1	GB T894.2-1986-25	轴用弹性挡圈	Washer	
81	1	GBT818 M4X8-8	盘头螺钉	Bolt	
82	1	GB T93-87 SW 4	弹垫	Washer	
83	1	GB T95-1985-4	平垫	Washer	
84	6	GB T 9456-ST4.8X16	自攻螺钉	Bolt	
85	1	Y01402	前支架	Front Bracket	
86	2	Y01404	前支架轴	Front Bracket Shaft	
87	2	Y01505-2	轮轴	Axle	
88	2	GB848-85-8	平垫圈	Washer	
89	2	Y01503	后支架轴套	Back Shaft Cover	
90	1	Y01504	后支架连接轴	Back Shaft Cover	
91	1	Y01506	调高板	Height Adjust Board	
92	3	Y01507	铆钉	Rivet	
93	1	Y01508	档位旋帽	Ward Turncap	
94	1	Y01513	后左支架板	Back Left Board	
95	1	Y01514	后右支架板	Back Right Board	
96	1	Y01515	档位杆	Ward Lever	
97	2	Y01516	轮轴	Axle	
98	2	6901LL-GBT276-94	深沟轴承	Bearing	
99	2	Y01801	8英寸轮毂	8"Wheel	
100	2	Y01802	8英寸外胎	8" Inch Tire	
101	2	Y01703	轮毂外盖	Wheel cover	
102	8	Y01704	冲压轴承	Pressing Bearing	
103	2	Y03801	8英寸轮毂内盖	8"Dust cover	
104	2	Y01713	12英寸轮毂	12"Wheel	
105	2	Y01714	12英寸外胎	12" Inch Tire	
106	2	Y01715	12英寸轮毂内盖	12"Dust cover	
107	1	Y01907	底板	Soleplate	
108	1	Y01910	集草袋部件	Grassbox	
109	1	Y01911	集草袋部件	Grassbox	
110	1	Y01912	集草袋部件	Grassbox	
111	2	Y01913	集草袋部件	Grassbox	
112	1	Y01914	集草袋部件	Grassbox	
113	1	Y01915	集草袋部件	Grassbox	
114	1	Y01916	集草袋部件	Grassbox	
115	2	Y01917	集草袋部件	Grassbox	
116	1	Y01918	集草袋部件	Grassbox	
117	4	GB T ST4.2X13	自攻螺钉	Bolt	
118	1	Y02112	连动杆	Connect rod	
119	2	Y01716	梅花螺母	Nut	
120	2	Y01711	梅花螺母	Nut	
121	1	Z-LI838	V带	Belt	
122	2	GB14-88-M10-50	马车螺栓	Bolt	
123	1	GGT1P70F-GH650-ASSY	OHV 173cc汽油机	Engine OHV 173cc	
		B&S DOV 700-ASSY	B&S 美国品牌动力	B&S DOV700 Engine	

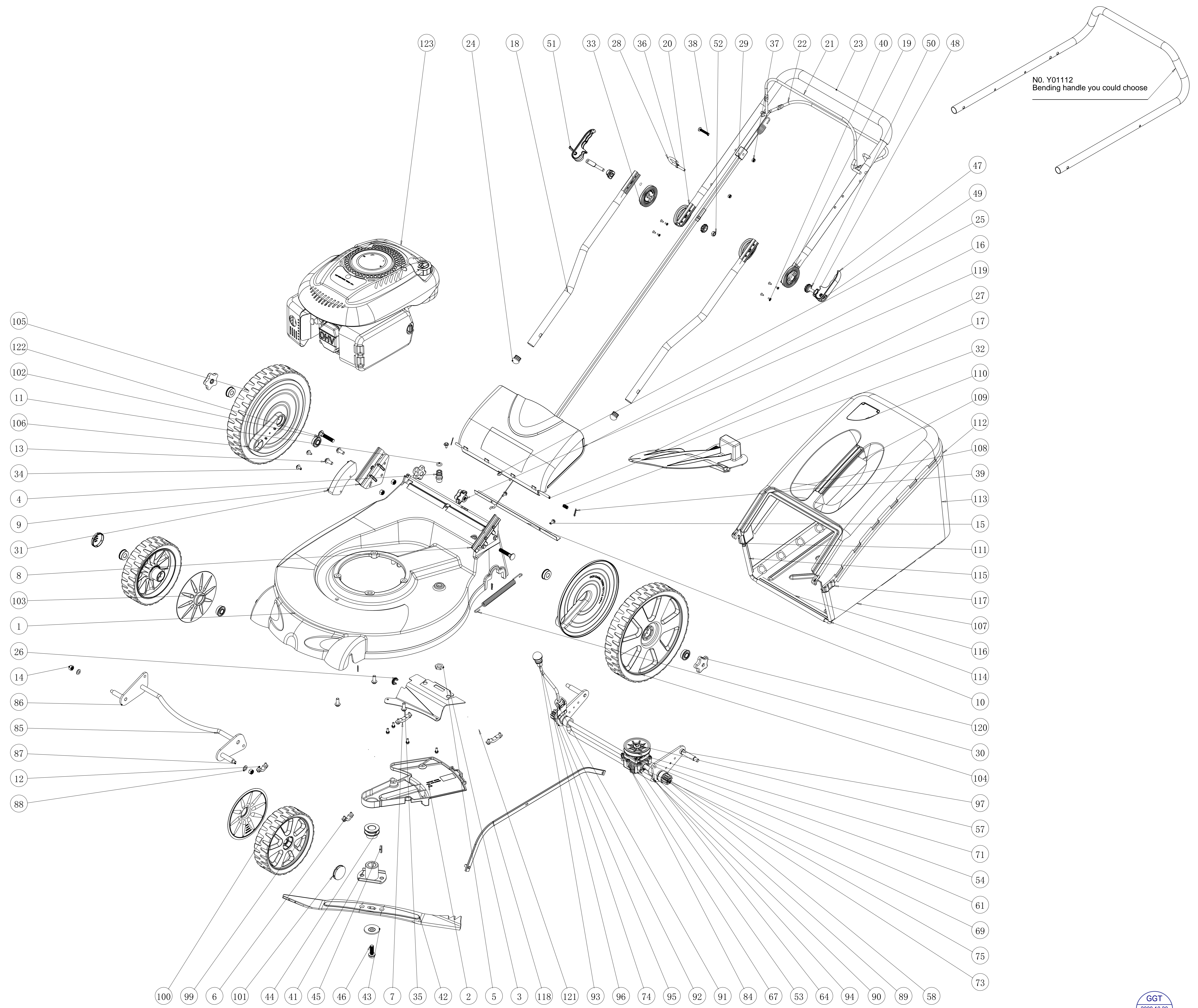

图纸的所有数据及复印件等资料, 未经宁海县帕菲特机械有限公司的书面许可是禁止拷贝、传播。
 THE INFORMATION CONTAINED IN THIS DRAWING IS THE SOLE PROPERTY OF
 (INSERT COMPANY NAME HERE). ANY REPRODUCTION IN PART OR AS A
 WHOLE WITHOUT THE WRITTEN PERMISSION OF (INSERT COMPANY NAME HERE)
 IS PROHIBITED.

ATTEN:
 1. Wearing parts mark by blue color.
 2. Secondary wearing parts mark by green color.
 3. Non-wearing parts mark by black color.

DESIGNER	NAME	DATE	2009.03.16
CHECKER	NAME	DATE	2009.03.22
APPROVER	NAME	DATE	2009.10.30
DATE	2009.10.30		

宁海县帕菲特机械有限公司
 YH58ASH-TI
 铝合金底盘割草机爆炸图
 YH58ASH-NEW

It is list for 1pc YH58ASH lawn mower, you can chose which spare parts you need.

NO.	QTY	GGT NO.	Chinese name	English name	How many pcs for spare parts you need.
1	1	Y03101	铝合金底盘	Chassis Aluminum	
2	1	Y03102	皮带盖	Strap Cover	
3	1	Y03103	覆盖底板	Back Cover Board	
4	1	Y03104	水接口	Clean coupler	
5	1	Y03105	塑料螺母	Plastic nut	
6	2	Y03115	前支架压板	Front bracket fixing board	
7	2	Y03116	后支架压板	Back bracket fixing board	
8	1	Y01106-L	扶手支架 L	Handle Bracket L	
9	1	Y01106-R	扶手支架 R	Handle Bracket R	
10	1	Y03118	防护板	Protection plank	
11	1	Y03119	O型圈	O type turn	
12	13	GB5789-86-M5x12	六角法来螺栓	Bolt	
13	4	GB5789-86-M8x16	六角法来面螺栓	Bolt	
14	6	GB6182-M8	六角螺母	Nut	
15	2	GB6561-86-ST48-12	自攻螺钉	From offend bolt	
16	1	Y01108	防护罩	Shield	
17	1	Y01109	防护罩轴	Shield Shaft	
18	2	Y03112	下扶手	Lower Handle	
19	2	Y03114	内旋转齿盘	Inner ratchet clamp	
20	1	Y03117	上扶手	Upper Handle	
21	1	Y01113-2	熄火开关	Stop Switch	
22	1	Y01114-2	自走开关	Drive Switch	
23	1	Y01115-2	软扶手套	Foam Glove	
24	2	Y01120	装饰盖	Decorate Cover	
25	1	Y01123	草盖扭簧	Spring for Flap	
26	2	Y01124	间距衬套	Space Bush	
27	1	Y01125	覆盖板	Cover Board	
28	1	Y01128	挂扣	Rope Guide	
29	1	Y02321	自走拉线	Drive cable	
30	1	Y01130	调高拉簧	Spring	
31	1	Y01131	档位板	Ward Board	
32	1	Y01132	弹簧	Spring	
33	2	Y03113	外旋转齿盘	Outer ratchet clamp	
34	3	GB6561-86-.ST4.8x12	自攻螺丝	Bolt	
35	3	GB5789-86-M8x20	六角法来面螺栓	Bolt	
36	1	GB6170A-M6	六角螺母	Nut	
37	2	GB6182-M6	六角螺母	Nut	
38	1	GB818-M6x35	螺栓	Bolt	
39	4	GB91-86-10	销	Pin	
40	8	GBT5283-85-ST3.5-9.5	自攻螺钉	From offend bolt	
41	1	Y01201	刀片支架	Blade Bracket	

42	1	Y02202	刀片	Blade	
43	1	Y01203	刀片垫片	Washer	
44	1	Y01204	Z型V带轮	Belt Wheel	
45	1	Y01209	曲轴长键	Key	
46	1	3-8-24UNF-2B	英制六角螺栓	Bolt	
47	2	Y01205	快速扳手	Quick Fix Handle	
48	2	Y03206	扳手锁块	Lock	
49	2	Y03207	拉杆	Pull Rod	
50	2	Y01208	自锁螺母套	Locknut Cover	
51	2	GB879-86-6x20	弹性圆柱销	Pin	
52	2	GB6170-86-M8	六角薄螺母	Nut	
53	1	Y02301	齿轮箱体	Gearcase Upper	
54	1	Y02302	齿轮箱盖	Gearcase Cover	
55	1	Y02303	拨叉	Fork	
56	1	Y02304	伞齿	Gear	
57	1	Y02305	锥齿	Pinion	
58	1	Y02306	驱动轴	Driver Shaft	
59	1	Y02307	衬套	Liner bushing	
60	1	Y02308	离合动套	Clutch sleeve	
61	1	Y02309	拨杆	Rod	
62	1	Y02310	垫片	Washer	
63	1	Y02311	平面轴承	Plane bearing	
64	1	Y02312	复位拉簧	Spring	
65	1	Y02313	离合弹簧	Spring	
66	2	Y02314	垫片	Washer	
67	1	Y02315	拉簧	Spring	
68	1	Y02316	O形圈	O circle	
69	3	Y02317	油封	Seals	
70	1	Y02318	O形圈	O circle	
71	1	Y01308-2	V带轮	Pulley	
72	2	Y01310	传动销	Groove Pin	
73	1	Y01312	直齿L	GearL	
74	1	Y01313	直齿R	GearR	
75	2	GB894_1-86-12	轴用弹性挡圈	Washer	
76	1	6001LL-GBT276-94	深沟球轴承	Bearing	
77	1	GB879-86-4x30	弹性圆柱销	Pin	
78	1	GB8931-28	孔用弹性挡圈	Washer	
79	1	GB_T8792-2000-4X16	弹性圆柱销	Pin	
80	1	GB_T894.2-1986-25	轴用弹性挡圈	Washer	
81	1	GBT818 M4X8-8	盘头螺钉	Bolt	
82	1	GB_T93-87_SW 4	弹垫	Washer	
83	1	GB_T95-1985-4	平垫	Washer	
84	6	GB_T 9456-ST4.8X16	自攻螺钉	Bolt	
85	1	Y01402	前支架	Front Bracket	
86	2	Y01404	前支架轴	Front Bracket Shaft	
87	2	Y01505-2	轮轴	Axle	
88	2	GB848-85-8	平垫圈	Washer	

89	2	Y01503	后支架轴套	Back Shaft Cover	
90	1	Y01504	后支架连接轴	Back Shaft Cover	
91	1	Y01506	调高板	Height Adjust Board	
92	3	Y01507	铆钉	Rivet	
93	1	Y01508	档位旋帽	Ward Turncap	
94	1	Y01513	后左支架板	Back Left Board	
95	1	Y01514	后右支架板	Back Right Board	
96	1	Y01515	档位杆	Ward Lever	
97	2	Y01516	轮轴	Axle	
98	2	6901LL-GBT276-94	深沟轴承	Bearing	
99	2	Y01801	8英寸轮毂	8"Wheel	
100	2	Y01802	8英寸外胎	8" Inch Tire	
101	2	Y01703	轮毂外盖	Wheel cover	
102	8	Y01704	冲压轴承	Pressing Bearing	
103	2	Y03801	8英寸轮毂内盖	8"Dust cover	
104	2	Y01713	12英寸轮毂	12"Wheel	
105	2	Y01714	12英寸外胎	12" Inch Tire	
106	2	Y01715	12英寸轮毂内盖	12"Dust cover	
107	1	Y01907	底板	Soleplate	
108	1	Y01910	集草袋部件	Grassbox	
109	1	Y01911	集草袋部件	Grassbox	
110	1	Y01912	集草袋部件	Grassbox	
111	2	Y01913	集草袋部件	Grassbox	
112	1	Y01914	集草袋部件	Grassbox	
113	1	Y01915	集草袋部件	Grassbox	
114	1	Y01916	集草袋部件	Grassbox	
115	2	Y01917	集草袋部件	Grassbox	
116	1	Y01918	集草袋部件	Grassbox	
117	4	GB_T ST4.2X13	自攻螺钉	Bolt	
118	1	Y02112	连动杆	Connect rod	
119	2	Y01716	梅花旋扭	Nut	
120	2	Y01711	梅花旋扭	Nut	
121	1	Z-Li838	V带	Belt	
122	2	GB14-88-M10-50	马车螺栓	Bolt	
123	1	GGT1P70F-GH650-ASSY	OHV 173cc汽油机	Engine OHV 173cc	