

310-0500

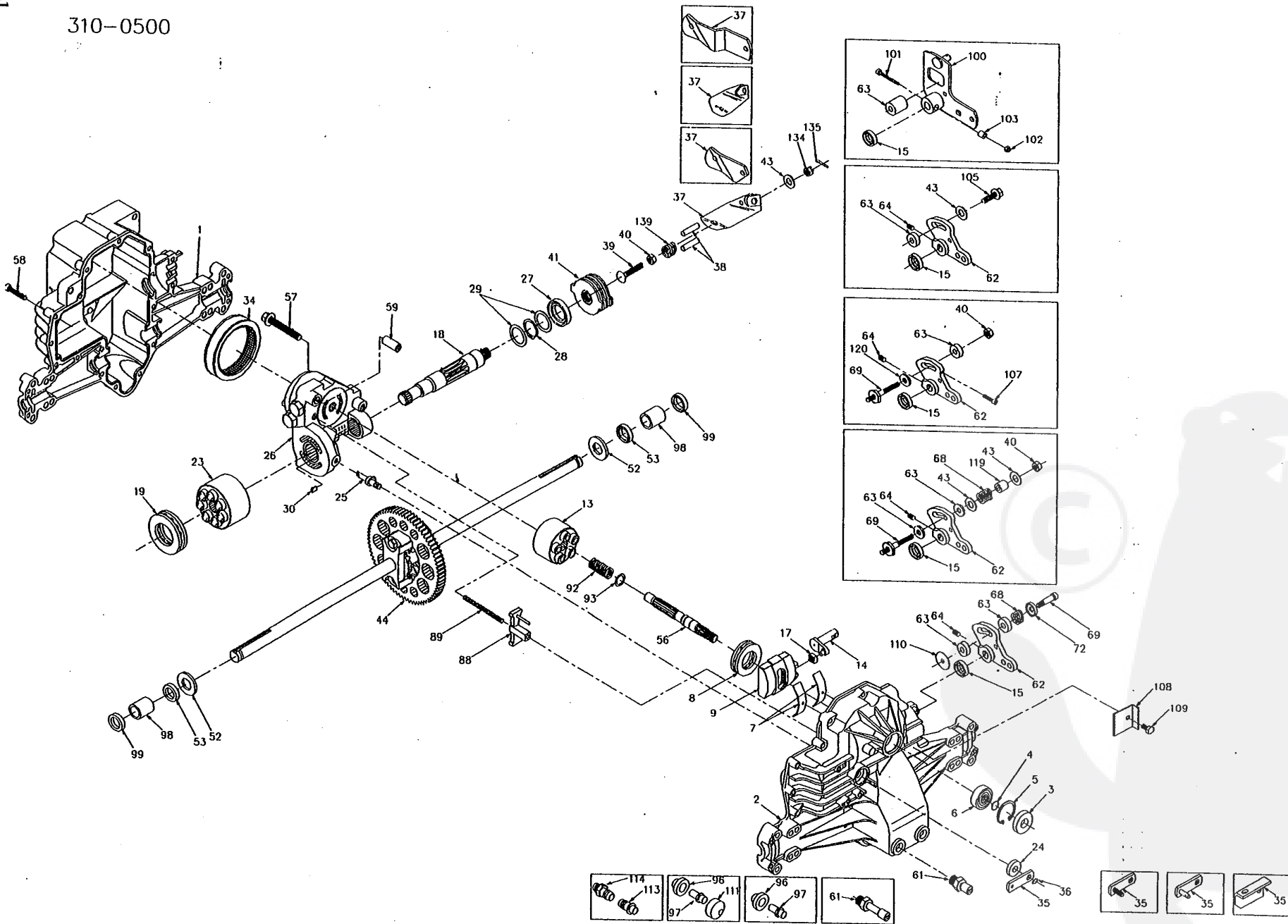

UNIT #	LOWER HSG	UPPER HSG ASSY	CENTER SECTION ASSY	BYPASS ARM	BRAKE ARM	DIFF. ASSY	INPUT SHAFT	BREATHER	CONTROL ARM	OEM CROSS REF NO.
311-0500	44863RM	70122	70214	50128	23710	70128	50005	50133,50134	50254	1708579
312-0500	50104	70124	70214	50128	23710	70129	50005	50133,50134,50198	NONE	817-3000
313-0500	44863RM	70122	70214	50128	44094	70128	50005	50042	45007	718-0254
314-0500	44863RM	70123	70134	50177	50127	70127	50005	50133,50134,50198	50170	20001-772-7000
315-0500	44863RM	70158	70214	44866	50131	70128	2003021		50271	88-6430
316-0500	44863RM	70158	70214	44866	50131	70128	2003021		50139	92-8783
317-0500	44863RM	70122	70214	50128	44094	70128	50005	70109,70110	50254	774711
318-0500	44863RM	70122	70214	50128	44094	70128	50005	70109,70110	50254	1709811
319-0500	44863RM	70122	70214	50270	23710	70128	50005	70109,70110	50254	140607
321-0500	44863RM	70158	70214	44866	50131	70128	2003021		50294	92-9790
322-0500	44863RM	70122	70214	50128	44094	70128	50005	70109,70110	45007	1713761
323-0500	44863RM	70158	70214	44866	50131	70128	2003021		50294	64-6775

ITEM NO.	HYDRO-GEAR PART NO.	DESCRIPTION
1	44863RM	LOWER HSG
	50104	
2	70122	UPPER HSG ASSEMBLY
	70123	
	70124	
	70158	
3	9008000-0128	LIP SEAL
4	2003016	WIRE RETAINING RING
5	2003052	RETAINING RING
6	2003043	SHAFT BALL BEARING
7	2003023	CRADLE BEARING
8	50551	THRUST BEARING 30 X 52 X 13
9	2003087	VARIABLE SWASHPLATE
13	70079	CYLINDER BLOCK ASSEMBLY
14	2003005	TRUNNION ARM
15	9008000-0128	LIP SEAL
17	2000015	SLOT GUIDE
	50123	
18	50449	MOTOR SHAFT
19	50552	THRUST BEARING 42 X 68 X 16
23	70082	CYLINDER BLOCK ASSEMBLY
24	45074	LIP SEAL
25	2003555	BYPASS ACTUATOR
26	70134	CENTER SECTION ASSEMBLY
	70214	
27	45075	LIP SEAL
28	50007	RETAINING RING
29	44872	WASHER
30	2003554	BYPASS PLATE
34	44984	OIL FILTER ELEMENT
35	44866	BYPASS ARM
	50128	
	50177	
	50270	
36	44870	RETAINING RING
37	23710	BRAKE ARM
	44094	
	50127	
	50131	
38	44891	ACTUATING PIN
39	50316	BOLT-5/16-24 X 1-3/4
40	50317	HEX LOCK NUT 5/16-24
41	70135	BRAKE ROTOR/STATOR ASSEMBLY
43	44130	WASHER-7/16 X 7/8 X .060
44	70128	DIFFERENTIAL ASSEMBLY
	70127	
	70128	
	70129	
49	44133	NUT, 1/4-20 HEX HEAD JAM
52	44875	WASHER-3/4 X 1.5 X .13
53	45078	SEAL-.75 X 1.25 X .250
56	2003021	INPUT SHAFT

ITEM NO.	HYDRO-GEAR PART NO.	DESCRIPTION
57	50016	BOLT, 3/4-24 X 2.5
58	44876	TORX HEAD CAP SCREW
59	50002	PIN
61	50042	BREATHER
62	45007	CONTROL ARM
	50170	
	50254	
63	50034	DAMPENER PUCK
	50281	
	50156	SPACER
	50278	
64	50018	SET SCREW
65	44123	BOLT, 1/4-20 X 1.38
68	50067	SPRING
	50277	
69	50032	SOCKET HEAD SHOULDER SCREW
	50284	5/16-24 STUD
	50282	FLANGE HEX SCREW-5/16-24 X 1.0
72	50076	CUP WASHER
88	50148	LEVELER
89	50149	LEVELER SPRING
90	50122	PULLEY
92	2003014	BLOCK SPRING
93	2003017	BLOCK THRUST WASHER
96	50133	BUSHING, VENT
97	50134	VENT
98	50137	SLEEVE BEARING
99	50119	WIPER SEAL
100	50139	CONTROL ARM
	50271	
	50294	
101	50140	SOCKET HEAD CAP SCREW
102	50141	NUT, 10-24
103	50142	SPACER
105	50282	FLANGE HEX SCREW, 5/16-24 X 1
107	50172	SPEED ADJUSTMENT SCREW
108	50178	BRAKE STOP
109	50188	SCREW, 1/4-20 X 1/2
110	50198	WASHER
111	50196	CAP, VENT
113	70109	CAP-VENT ASSEMBLY
114	70110	FITTING-O RING ASSEMBLY
119	50278	SPACER
120	50281	DAMPENER PUCK
134	44142	SLOTTED NUT
135	44101	COTTER PIN
136	50384	EXTENSION SPRING
137	50383	DRIVE PIN
138	23770	SPACER
139	50431	COMPRESSION SPRING
140	50289	HEX, NUT 5/16-24