

176057
311-3500

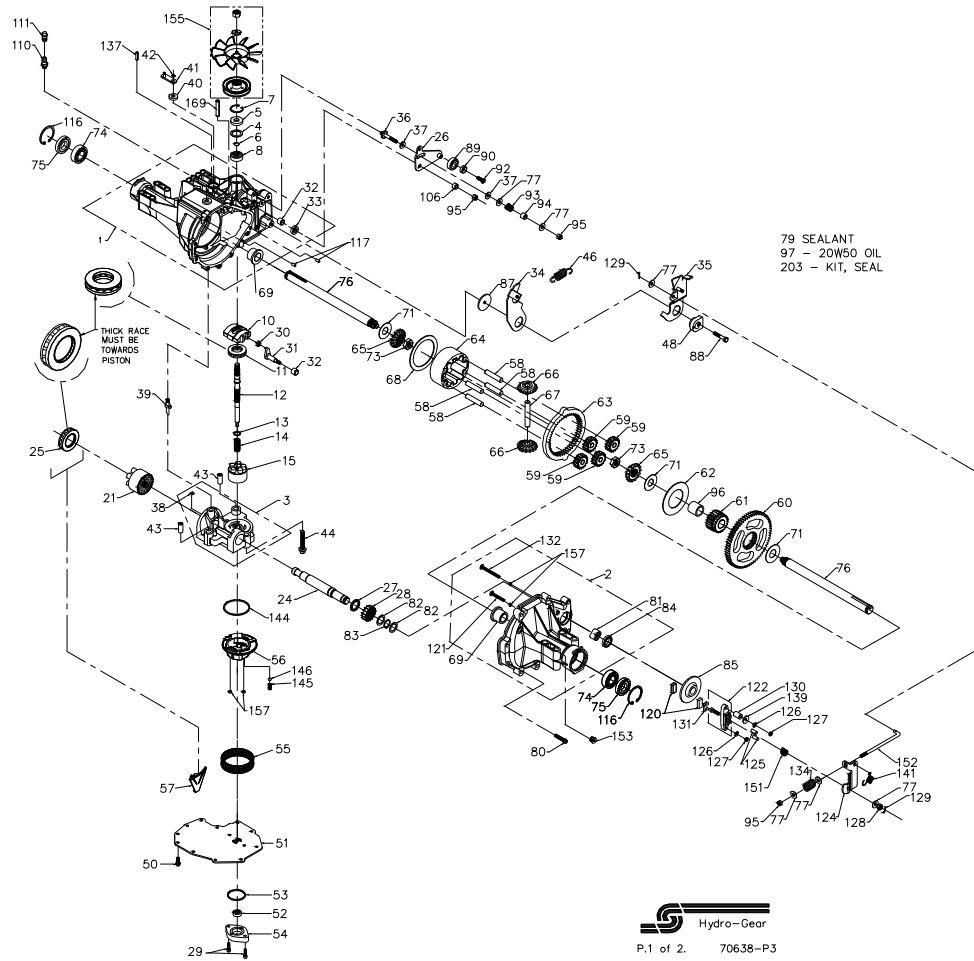

176057
311-3500

ITEM #	PART #	QTY	DESCRIPTION	ITEM #	PART #	QTY	DESCRIPTION	ITEM #	PART #	QTY	DESCRIPTION
1	70297	1	MAIN HOUSING ASSEMBLY	42	44870	1	RING, RETAINING	110	70110	1	FITTING, O-RING ASS'Y
		1	MAIN HOUSING	43	50002	2	PIN			1	FITTING, PLASTIC HOSE
		1	LIP SEAL	44	50016	3	SCREW, 3/8-24 X 2.5	111	70109	1	O-RING
		1	FLANGE BEARING	46	50833	1	SPRING, NEUTRAL			1	VENT, CAP ASS'Y
		1	TRUNNION BUSHING	48	50835	1	PUCK, ADJUSTING			1	VENT, PLASTIC
2	70300	2	CRADLE BEARING	50	50752	11	SCREW, 1/4-20 X .75			1	VENT, CAP
		1	R.H. HOUSING ASSEMBLY	51	50972	1	COVER, LOWER	116	50859	2	RING, RETAINING
		1	R.H. HOUSING	52	50273	1	GEROTOR ASSEMBLY	117	9004800-2506	2	PIN, STD HDLS
		1	FLANGE BEARING	53	9004101-1340	1	O-RING	120	44132	2	PUCK, BRAKE
		2	O RING	54	50260	1	COVER, GEROTOR	121	50874	1	BOLT, RIB NECK 2"
		1	RIB NECK BOLT, 2"	55	70538	1	KIT, FILTER	122	70633	1	YOKER, BRAKE ASSEMBLY
		1	RIB NECK BOLT, 3"			2	GASKET .10X.16X4.24	124	50911	1	ARM, BRAKE
		1	NEEDLE BEARING (SCE1412)	56	51156	1	MANIFOLD, CHARGE	125	44127	2	PINS, BRAKE
		1	LIP SEAL (.875I.D.x1.30D.x.25)	57	50796	1	BEARING, MOTOR RETAINER	126	43177	2	LOCKWASHER, 1/4"
3	70684	1	KIT, CENTER SECTION	58	50776	4	PIN, CARRIER	127	43178	2	NUT, 1/4-20
		1	BUSHING .50X.60X.50	59	50763	4	GEAR, 15T PLANET	128	44142	1	NUT, CASTLE 5/16-24
		1	BUSHING .90X1.02X.75	60	50646	1	GEAR, 67T SPUR	129	44101	2	PIN, COTTER
		1	PLATE, BYPASS	61	50645	1	GEAR, 21 TOOTH SUN	130	23711	1	SPACER
		1	CHECK PLUG ASSEMBLY, .044	62	50769	1	PLATE, PLANET THRUST	131	44134	1	PUCK, PLATE
		1	CHECK PLUG ASSEMBLY, NO BLEED	63	50764	1	GEAR, 51T RING	132	50865	1	BOLT, RIB NECK 3"
		1	SPACER	64	50765	1	CARRIER, PLANETARY	134	50915	1	SPRING, BRAKE
4	2003018	1	LIP SEAL 15 X 35 X 7	65	51431	2	GEAR, MITER DIFF. (SPLINED)	137	50882	1	PIN, SPRING
5	9008000-0128	1	RING, WIRE RETAINING	66	51432	2	GEAR, MITER DIFF. (SPLINED)	139	44278	1	WASHER, 7/80D X .265ID X .125 THK
6	2003016	1	RING, RETAINING	67	50766	1	SHAFT, DIFFERENTIAL	141	50884	1	SPRING, BRAKE ARM BIAS
7	2003052	1	BEARING, BALL .59 X 1.38 X .43	68	50767	1	PLATE, DIFF. THRUST	144	50974	1	O RING, 2.987 ID .103 THK
8	2003043	1	SWASHPLATE, VARIABLE	69	50768	2	BEARING, FLANGE	145	51157	1	SPRING, RELIEF
10	2003087	1	BEARING, THRUST 30 X 52 X 13	70	50769	2	WASHER 1.0 X 2.25 X .04	146	9001214-4400	1	BALL, 7/16
11	50551	1	SHAFT, INPUT	71	50788	3	NUT, HEX JAM 5/8-18	151	50919	1	COMP. SPRING, BRAKE ANTI-DRAW
12	50795	1	WASHER, THRUST .591X.787X.040	73	50791	2	BEARING, BALL 6205-1	152	50914	1	BRAKE PULL ROD
13	2003017	1	SPRING, BLOCK	74	50771	2	SEAL 1"ID X 2.0472" X .375"	153	9005110-5600	1	PLUG, STRAIGHT THREAD
14	2003014	1	10cc CYLINDER BLOCK ASSEMBLY	75	50772	2	SHAFT, AXLE	155	70460	1	KIT, FAN/PULLEY
15	70331	1	10cc CYLINDER BLOCK	76	50663	2	WASHER .343 X .880 X .062			1	NUT, JAM 1/2-20
		5	10cc PISTON	77	44130	6	WASHER .324 X 1.960 X .146			1	WASHER, OD SLOTTED, .53 X 1.63 X .06
		5	10cc PISTON SPRING	79	50928	1	SCREW, TORX HEAD 5/16-18			1	PULLEY
		5	PISTON SEAT WASHER	80	50858	9	SCREW, 5/16-24 X 1-1/2			1	FAN
21	70082	1	21cc CYLINDER BLOCK ASSEMBLY	81	44752	1	BEARING, NEEDLE (SCE1412)	157	50977	4	O-RING, .070 X .239
		1	21cc CYLINDER BLOCK	82	50777	2	WASHER .885 X 1.250 X .038	169	51463	1	PIN, SPRING 5/16 X 1.75
		7	PISTON SEAT WASHER	83	50775	1	RING, RETAINING	203	70492	1	KIT, SEAL
		7	21cc PISTON	84	50773	1	SEAL, LIP .875I.D.x1.30D.x.25			1	SEAL-LIP 15X5X37
		7	21cc PISTON SPRING	85	50779	1	DISK, BRAKE			1	SEAL-LIP 12X25X7
24	50662	1	SHAFT, MOTOR	87	50836	1	WASHER .324 X 1.960 X .146			1	SEAL-LIP 10X25X7
25	50552	1	BEARING, THRUST 42 X 68 X 16	88	50837	1	SCREW, 5/16-24 X 1-1/2			1	O-RING, .103X1.862
26	50857	1	ARM, CONTROL	89	44147	1	SPACER, LOCATING			1	SEAL 25X52X10
27	50774	1	SPACER	90	50839	1	SCREW, LOCATING			1	LIP SEAL (.875 I.D.X1.3 O.D. X.25)
28	50661	1	GEAR, 16T PINION	92	50870	1	SCREW, COUNTERSUNK 5/16-18			4	O-RING, .070X.239
29	50975	2	CAPSCREW, M6 X 1-25	93	50277	1	SPRING			1	KIT, O-RING, MANIFOLD
30	2000015	1	SLOT GUIDE	94	50278	1	SPACER			1	PIN, SPRING 5/16 X 1.75
31	50807	1	ARM, TRUNNION TAPERED SQUARE	95	50108	3	NUT, HEX LOCK 5/16-24			1	PIN, SPRING 1/4 X 1.00
32	2003009	1	BUSHING, TRUNNION	96	50866	1	BEARING, SLEEVE				
33	9008000-0126	1	SEAL, LIP 12 X 25 X 7	97	50867	122oz	20W-50 OIL				
34	50831	1	ARM, RETURN	106	50850	1	SPACER, TRUNNION				
35	50832	1	ARM, ACTUATING	108	9005200-5600	1	PLUG, PLASTIC				
36	50284	1	STUD, 5/16-24								
37	50281	2	PK, FRICTION								
38	70680	1	KIT, BYPASS PLATE								
39	2003555	1	ACTUATOR, BYPASS								
40	45074	1	SEAL, LIP 10 X 25 X 7								
41	50270	1	ARM, BYPASS								