

7649
317-3000

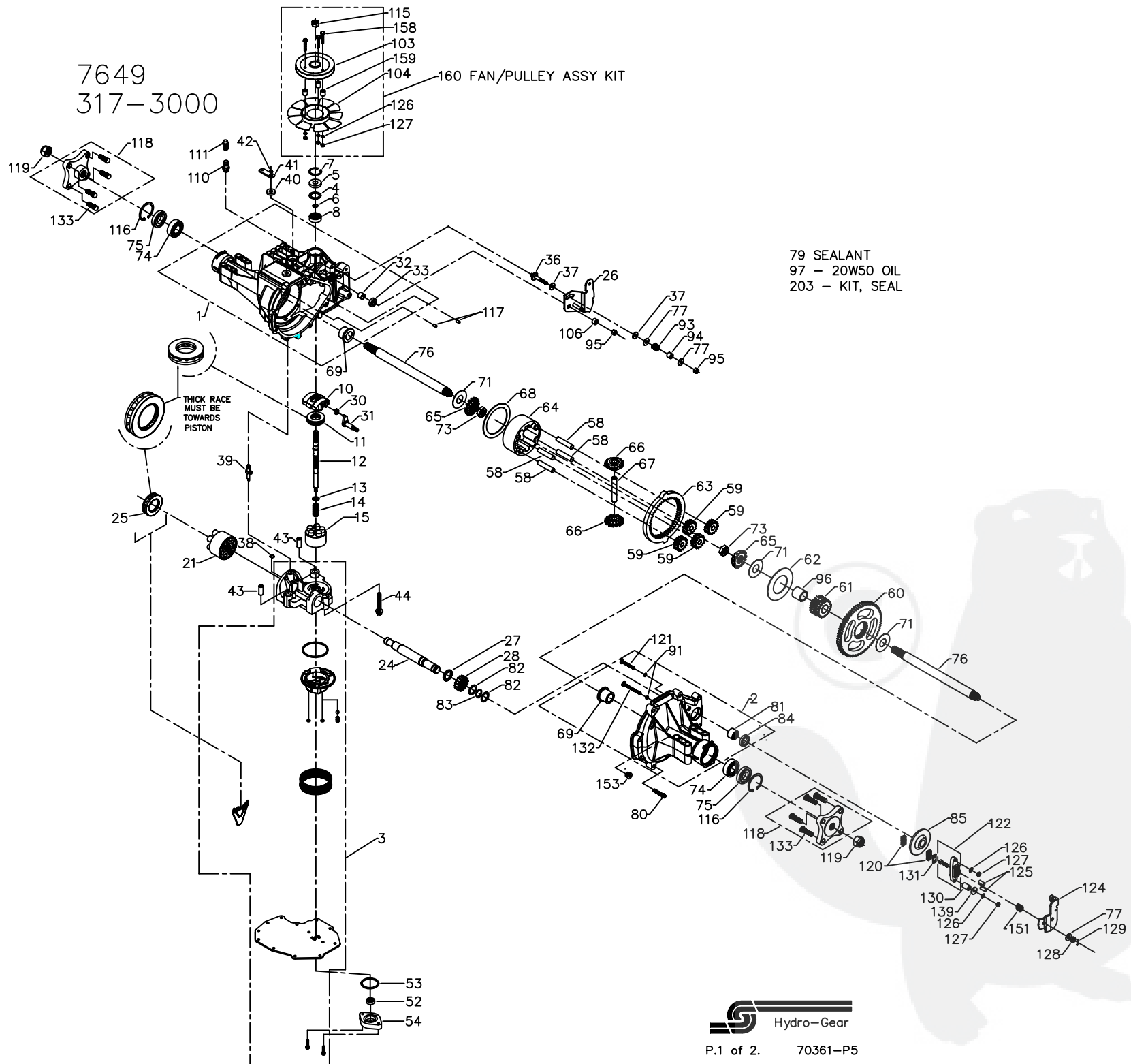

7649
317-3000

ITEM #	PART #	QTY	DESCRIPTION
1	70297	1	MAIN HOUSING ASSEMBLY
		1	MAIN HOUSING
		1	LIP SEAL
		1	FLANGE BEARING
		1	TRUNNION BUSHING
2	70298	2	CRADLE BEARING
		1	R.H. HOUSING ASSEMBLY
		1	R.H. HOUSING
		1	FLANGE BEARING
		2	O RING
		1	RIB NECK BOLT, 2"
		1	RIB NECK BOLT, 3"
		1	NEEDLE BEARING (SCE1412)
		1	LIP SEAL (.875I.D.x1.30.D.x.25)
3	70439	1	KIT, MANIFOLD
		1	KIT, CENTER SECTION
		1	CENTER SECTION
		1	BEARING .50 X .60 X .50
		1	BUSHING .90 X 1.02 X .75
		1	PLATE, BYPASS
		2	CHECK PLUG ASSEMBLY, .027
		2	CAPSCREW M6X1-22
		1	COVER, LOWER
		1	KIT, FILTER
		1	MANIFOLD, CHARGE
		1	RETAINER, MOTOR BEARING
		1	O RING .103X2.987
		1	SPRING, RELIEF
		1	BALL 7/16
		2	O-RING .070X.239
4	2003018	1	SPACER
5	9008000-0128	1	SEAL-LIP
6	2003016	1	WIRE RETAINING RING
7	2003052	1	RETAINING RING
8	2003043	1	BALL BEARING
10	2003087	1	VARIABLE SWASHPLATE
11	50551	1	THRUST BEARING 30 X 52 X 13
12	50795	1	INPUT SHAFT
13	2003017	1	BLOCK THRUST WASHER
14	2003014	1	BLOCK SPRING
15	70331	1	10cc CYLINDER BLOCK ASSEMBLY
		1	10cc CYLINDER BLOCK
		5	10cc PISTON
		5	10cc PISTON SPRING
		5	PISTON SEAT WASHER
21	70082	1	21cc CYLINDER BLOCK ASSEMBLY
		1	21cc CYLINDER BLOCK
		7	PISTON SEAT WASHER
		7	21cc PISTON
		7	21cc PISTON SPRING
24	50662	1	OUTPUT (MOTOR) SHAFT
25	50552	1	THRUST BEARING 42 X 68 X 16
26	51013	1	CONTROL ARM
27	50774	1	SPACER
28	50661	1	16T PINION GEAR
30	2000015	1	SLOT GUIDE
31	50807	1	TRUNNION ARM
32	2003009	1	TRUNNION BUSHING
33	9008000-0126	1	LIP SEAL
36	50284	1	5/16-24 STUD
37	50281	2	PUCK, FRICTION

ITEM #	PART #	QTY	DESCRIPTION
38	70680	1	KIT, BYPASS PLATE
39	2003555	1	BYPASS ACTUATOR
40	45074	1	LIP SEAL
41	44866	1	BYPASS ARM
42	44870	1	RETAINING RING
43	50002	2	PIN
44	50016	3	SCREW
49	50783	1	GASKET, LOWER
50	50437	11	SCREW-SELF TAPPING
52	50273	1	GEROTOR ASSEMBLY
53	9004101-1340	1	O-RING
54	50260	1	GEROTOR COVER
55	70380	1	MANIFOLD FILTER KIT
57	50796	1	RETAINER, MOTOR BEARING
58	50776	4	PIN, CARRIER
59	50763	4	15T PLANET GEAR
60	50646	1	67T SPUR GEAR
61	50645	1	21 TOOTH SUN GEAR
62	50769	1	PLANET THRUST PLATE
63	50764	1	51T RING GEAR
64	50765	1	PLANETARY CARRIER
65	50647	2	MITER GEAR, DIFF. (SPLINED)
66	50648	2	MITER GEAR, DIFF.
67	50766	1	SHAFT, DIFFERENTIAL
68	50767	1	DIFF. THRUST PLATE
69	50768	2	FLANGE BEARING
71	50788	3	WASHER 1.0 X 2.25 X .04
73	50791	2	HEX JAM NUT, 5/8-18
74	50771	2	BALL BRG 6205-1
75	50772	2	SEAL 1"ID x 2.0472" x 0.375"
76	50825	2	SHAFT, AXLE
77	44130	3	WASHER
79	50928	1	SEALANT
80	50868	9	TORX HEAD SCREW, 5/16-18
81	44752	1	NEEDLE BEARING (SCE1412)
82	50777	2	WASHER
83	50775	1	RETAINING RING
84	50773	1	LIP SEAL (.875I.D.x1.30.D.x.25)
85	50779	1	BRAKE DISK
91	50867	2	ORING, 0.070 X 0.239
93	50277	1	SPRING, FRICTION PACK
94	50278	1	SPACER, FRICTION PACK
95	50108	2	HEX LOCK NUT 5/16-24
96	50866	1	SLEEVE BEARING
97		122oz	20W-50 OIL
103	50302	1	PULLEY
104	50307	1	FAN
106	50850	1	SPACER, TRUNNION
110	70110	1	FITTING-O RING ASSEMBLY
		1	PLASTIC HOSE FITTING
		1	O-RING
111	70109	1	CAP-VENT ASSEMBLY
		1	PLASTIC VENT
		1	CAP-VENT
115	44133	1	JAM NUT

ITEM #	PART #	QTY	DESCRIPTION
116	50859	2	RETAINING RING
117	9004800-2506	2	STD HDLS PIN
118	70314	2	HUB ASSEMBLY
		8	WHEEL STUD, 7/16-14
		2	HUB
119	50863	2	NUT, HEX 3/4-16
120	44132	2	PUCK, BRAKE
121	50874	1	RIB NECK BOLT, 2"
122	70633	1	BRAKE YOKE ASSEMBLY
124	50916	1	ARM, BRAKE
125	44127	2	PINS, BRAKE
126	43177	5	LOCKWASHER, 1/4"
127	43178	5	NUT, 1/4-20
128	44142	1	NUT, CASTLE
129	44101	1	COTTER PIN
130	23711	1	SPACER
131	44134	1	PUCK PLATE
132	50865	1	RIB NECK BOLT, 3"
133	50869	8	WHEEL STUD 7/16-14
139	44278	1	WASHER, 7/80D X .265ID X .125 THK
144	70381	1	MANIFOLD O-RING KIT
151	50919	1	COMP. SPRING, BRAKE ANTI-DRAG
153	9005110-5600	1	PLUG, STRAIGHT THREAD
156	50976	1	MANIFOLD O-RING
157	50977	2	SCREW O-RING
158	44276	3	SCREW 1/4-20X1/2
159	50259	3	SPACER
160	70243	1	FAN/PULLEY ASS'Y KIT
		1	PULLEY
		1	FAN
		1	JAM NUT
		3	LOCKWASHER
		3	NUT, 1/4-20
		3	SCREW, 1/4-20X1-1/2
		3	SPACER
203	70492	1	KIT, SEAL
		1	SEAL-LIP 15X5X37
		1	SEAL-LIP 12X25X7
		1	SEAL-LIP 10X25X7
		1	O-RING, .103X1.862
		2	SEAL 25X52X10
		1	LIP SEAL (.875 I.D.X1.3 O.D. X.25)
		4	O-RING, .070X.239
		1	KIT, O-RING, MANIFOLD

