

K12111121
323-3000

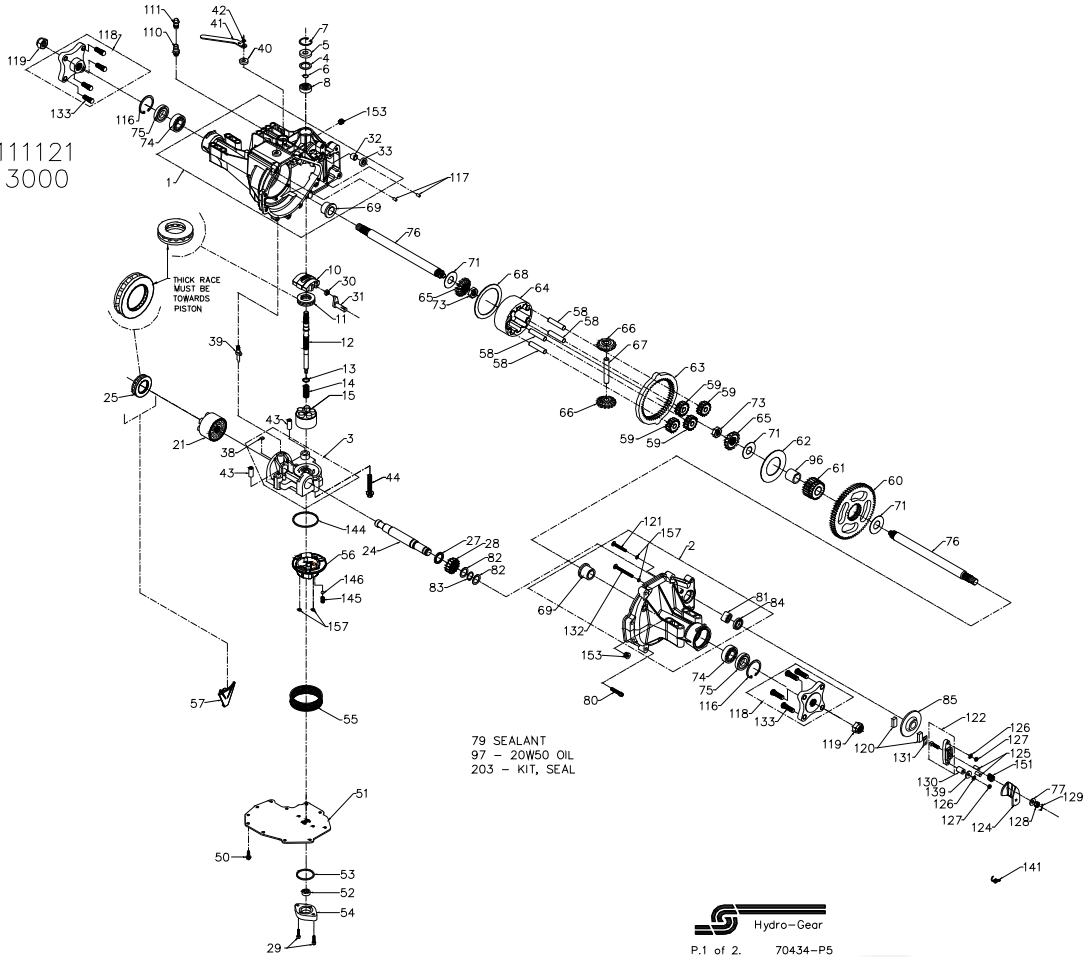

Hydro-Gear
P.1 of 2. 70434-P5

K12111121
323-3000

ITEM #	PART #	QTY	DESCRIPTION
1	70433	1	HOUSING, MAIN ASSEMBLY
		1	HOUSING, MAIN
		2	BEARING, CRADLE
		1	BUSHING, TRUNNION
		1	SEAL, LIP 12X25X7
2	70298	1	BEARING, FLANGE
		1	HOUSING, R.H. ASSEMBLY
		1	HOUSING, R.H.
		2	O-RING .070X.239
		1	BOLT, 2" RIB NECK
		1	BOLT, 3" RIB NECK
		1	BEARING, NEEDLE .875X1.125X.750
		1	SEAL, LIP .875X1.375X.250
3	70683	1	KIT, CENTER SECTION
		1	CENTER SECTION
		1	BUSHING .50X.60X.50
		1	BUSHING .90X1.02X.75
		1	PLATE, BYPASS
		2	CHECK PLUG ASSEMBLY, .027
4	2003018	1	SPACER
5	9008000-0128	1	SEAL, LIP 15X35X7
6	2003016	1	RING, WIRE RETAINING
7	2003052	1	RING, RETAINING
8	2003043	1	BEARING, BALL 15X35X11
10	2003087	1	SWASHPLATE, VARIABLE
11	50551	1	BEARING, THRUST 30X52X13
12	50795	1	SHAFT, INPUT
13	2003017	1	WASHER, BLOCK THRUST
14	2003014	1	SPRING, BLOCK
15	70331	1	BLOCK, 10cc CYLINDER ASSEMBLY
		1	BLOCK, 10cc CYLINDER
		5	PISTON, 10cc
		5	SPRING, 10cc PISTON
21	70082	5	WASHER, PISTON SEAT
		1	BLOCK, 21cc CYLINDER ASSEMBLY
		1	BLOCK, 21cc CYLINDER
		7	WASHER, PISTON SEAT
		7	PISTON, 21cc
		7	SPRING, 21cc PISTON
24	50662	1	SHAFT, MOTOR
25	50552	1	BEARING, THRUST 42X68X16
27	50774	1	SPACER
28	50661	1	GEAR, 16T PINION
29	50975	2	CAPSCREW M6X1-25
30	2000015	1	GUIDE, SLOT
31	2003005	1	ARM, TRUNNION
32	2003009	1	BUSHING, TRUNNION
33	9008000-0126	1	SEAL, LIP 12X25X7
38	70680	1	KIT, BYPASS PLATE
39	2003555	1	ACTUATOR, BYPASS
40	45074	1	SEAL, LIP 10X25X7
41	50929	1	ARM, BYPASS
42	44870	1	RING, RETAINING
43	50002	2	PIN
44	50016	3	SCREW 3/8-24X2.5

ITEM #	PART #	QTY	DESCRIPTION
50	50752	11	SCREW 1/4-20X.75
51	50972	1	COVER, LOWER
52	50273	1	GEROTOR ASSEMBLY
53	9004101-1340	1	O-RING .103X1.862
54	50260	1	GEROTOR COVER
55	70538	1	KIT, FILTER
		2	GASKET .10X.16X4.24
		1	FILTER
56	51156	1	MANIFOLD, CHARGE
57	50796	1	RETAINER, MOTOR BEARING
58	50776	4	PIN, CARRIER
59	50763	4	GEAR, 15T PLANET
60	50646	1	GEAR, 67T SPUR
61	50645	1	GEAR, 21 TOOTH SUN
62	50769	1	PLATE, PLANET THRUST
63	50764	1	GEAR, 51T RING
64	50765	1	CARRIER, PLANETARY
65	50647	2	GEAR, MITER DIFF. (SPLINED)
66	50648	2	GEAR, MITER DIFF.
67	50766	1	SHAFT, DIFFERENTIAL
68	50767	1	PLATE, DIFF. THRUST
69	50768	2	BEARING, FLANGE
71	50788	3	WASHER 1.0X2.25X.04
73	50791	2	NUT, HEX JAM 5/8-18
74	50771	2	BEARING, BALL 25.4X52X15
75	50772	2	SEAL 1.000X2.049X.375
76	50825	2	SHAFT, AXLE
77	44130	1	WASHER .34X.88X.06
79	50928	1	SEALANT
80	50866	9	SCREW, TORX HEAD 5/16-18
81	44752	1	BEARING, NEEDLE .875X1.125X.750
82	50777	2	WASHER .88X1.24X.04
83	50775	1	RING, RETAINING
84	50773	1	SEAL, LIP .875X1.30X.25
85	50779	1	DISK, BRAKE
96	50866	1	BEARING, SLEEVE 1.0X1.31X1.34
97		122 OZ	OIL-20W50
110	70110	1	FITTING, O-RING ASS'Y
		1	FITTING, PLASTIC HOSE
		1	O-RING
		1	VENT, CAP ASS'Y
		1	VENT, PLASTIC
		1	VENT, CAP
111	70109	1	RING, RETAINING
		2	PIN, STD HDLS
		2	HUB, ASSEMBLY
		1	HUB
		4	BOLT, LUG 1/2-20
		2	NUT, HEX 3/4-16
		2	PUCK, BRAKE
		1	BOLT, 2" RIB NECK
		1	YOKE, BRAKE ASSEMBLY
		1	ARM, BRAKE
		2	PINS, BRAKE
		2	LOCKWASHER 1/4"
		2	NUT 1/4-20
		1	NUT, CASTLE
		1	PIN, COTTER
119	50863	2	BOLT, LUG 1/2-20
120	44132	2	NUT, HEX 3/4-16
121	50874	2	PUCK, BRAKE
122	70633	1	YOKE, BRAKE ASSEMBLY
124	50936	1	ARM, BRAKE
125	44127	2	PINS, BRAKE
126	43177	2	LOCKWASHER 1/4"
127	43178	2	NUT 1/4-20
128	44142	1	NUT, CASTLE
129	44101	1	PIN, COTTER

ITEM #	PART #	QTY	DESCRIPTION
130	23711	1	SPACER
131	44134	1	PUCK, PLATE
132	50865	1	BOLT, 3" RIB NECK
133	50869	8	STUD, WHEEL
139	44278	1	WASHER .875X.265X.125
141	50884	1	SPRING, BRAKE ARM BIAS
144	50974	1	O-RING .103X2.987
145	51157	1	SPRING, RELIEF
146	9001214-4400	1	BALL 7/16
151	50919	1	SPRING, COMP. BRAKE ANTI-DRAW
153	9005110-5600	2	PLUG, STRAIGHT THREAD
157	50977	4	O-RING .070X.239
203	70492	1	KIT, SEAL
		1	SEAL, LIP 15X35X7
		1	SEAL, LIP 12X25X7
		1	SEAL, LIP 10X25X7
		1	O-RING .103X1.862
		2	SEAL, LIP 1.000X2.049X.375
		1	SEAL, LIP .875X1.375X.250
		2	O-RING .070X.239
		2	O-RING .070X0.239
		1	KIT, O-RING, MANIFOLD

Hydro-Gear
P.2 of 2. 70434-P5