

329-3000

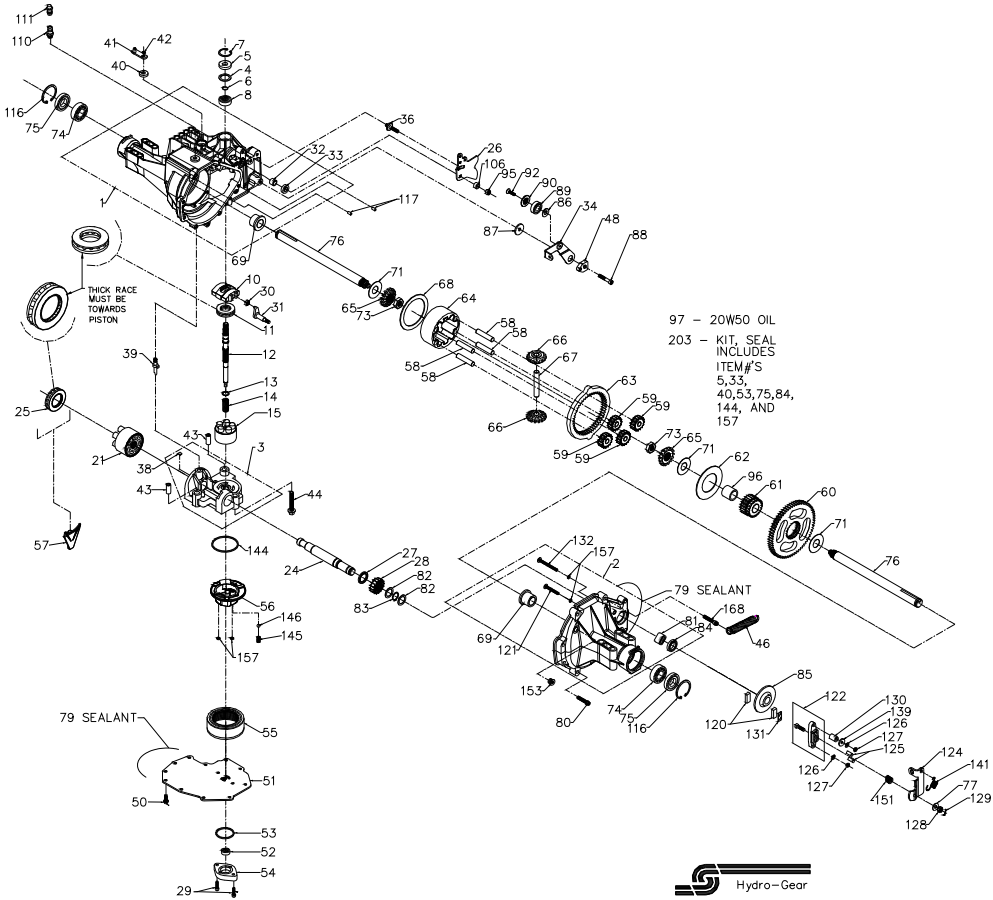

Hydro-Gear
P.1 of 2. 70558-P2

329-3000

ITEM #	PART #	QTY	DESCRIPTION	ITEM #	PART #	QTY	DESCRIPTION	ITEM #	PART #	QTY	DESCRIPTION
1	70297	1	HOUSING, MAIN ASSEMBLY	40	45074	1	LIP SEAL	111	70109	1	VENT, CAP ASSEMBLY
		1	HOUSING, MAIN	41	50270	1	BYPASS ARM			1	VENT, PLASTIC
		1	SEAL, LIP 12X25X7	42	44870	1	RETAINING RING			1	VENT, CAP
		1	BEARING, FLANGE	43	50002	2	PIN	116	50859	2	RING, RETAINING
		1	BUSHING, TRUNNION	44	50016	3	SCREW	117	9004800-2506	2	PIN, STD HDLS
		2	BEARING, CRADLE	46	51153	1	RETURN SPRING	120	44132	2	PUCK, BRAKE
2	70300	1	HOUSING, R.H. ASSEMBLY	48	51097	1	ADJUSTING PUCK	121	50874	1	RIB NECK BOLT, 2"
		1	HOUSING, R.H.	50	50752	11	SCREW 1/4-20X.75	122	70633	1	YOKE, BRAKE ASSEMBLY
		1	BEARING, FLANGE	51	50972	1	COVER, LOWER	124	50911	1	ARM, BRAKE
		2	O-RING .070X.239	52	50723	1	GEROTOR ASSEMBLY	125	44127	2	PINS, BRAKE
		1	RIB NECK BOLT, 2"	53	9004101-1340	1	O-RING .103X1.862	126	43177	2	LOCKWASHER, 1/4"
		1	BOLT, 3" RIB NECK	54	50260	1	COVER, GEROTOR	127	43178	2	NUT, 1/4-20
		1	BEARING, NEEDLE .875X1.125X.75	55	70538	1	KIT, FILTER	128	44142	1	NUT, CASTLE
		1	SEAL, LIP .875X1.30X.25			2	GASKET .10X.16X4.24	129	44101	1	COTTER PIN
3	70683	1	KIT, CENTER SECTION			1	FILTER	130	23711	1	SPACER
		1	CENTER SECTION	56	51156	1	MANIFOLD, CHARGE	131	44134	1	PUCK PLATE
		1	BUSHING .50X.60X.50	57	50796	1	RETAINER, MOTOR BEARING	132	50865	1	BOLT, 3" RIB NECK
		1	BUSHING .90X1.02X.75	58	50776	4	PIN, CARRIER	139	44278	1	WASHER, 7/800 X .265ID X .125 THK
		1	PLATE, BYPASS	59	50763	4	GEAR, 15T PLANET	141	50884	1	SPRING, BRAKE ARM BIAS
		2	CHECK PLUG ASSEMBLY, .027	60	50646	1	GEAR, 67T SPUR	144	50974	1	O-RING .103X2.987
4	2003018	1	SPACER	61	50645	1	GEAR, 21 TOOTH SUN	145	51157	1	SPRING, RELIEF
5	9008000-0128	1	SEAL, LIP 15X35X7	62	50769	1	PLATE, PLANET THRUST	146	9001214-4400	1	BALL, 7/16
6	2003016	1	RING, WIRE RETAINING	63	50764	1	GEAR, 51T RING	151	50919	1	COMP. SPRING, BRAKE ANTI-DRAG
7	2003052	1	RING, RETAINING	64	50765	1	CARRIER, PLANETARY	153	9005110-5600	1	PLUG, STRAIGHT THREAD
8	2003043	1	BEARING, BALL 15X35X11	65	50647	2	GEAR, MITER DIFF. (SPLINED)	157	50977	4	O-RING .070X.239
10	2003087	1	SWASHPLATE, VARIABLE	66	50648	2	GEAR, MITER DIFF.	168	51151	1	SCREW, SHOULDERED TORX HEAD 5/16-18
11	50551	1	BEARING, THRUST 30X52X13	67	50766	1	SHAFT, DIFFERENTIAL			1	KIT, SEAL
12	50795	1	SHAFT, INPUT	68	50767	1	PLATE, THRUST DIFF.	203	70492	1	SEAL, LIP 15X35X7
13	2003017	1	WASHER, BLOCK THRUST	69	50768	2	BEARING, FLANGE			1	SEAL, LIP 12X25X7
14	2003014	1	SPRING, BLOCK	71	50788	3	WASHER 1.0X2.25X.04			1	SEAL, LIP 10X25X7
15	70331	1	BLOCK, 10cc CYLINDER ASSEMBLY	73	50791	2	NUT, HEX JAM 5/8-18			1	O-RING .103X1.862
		1	BLOCK, 10cc CYLINDER	74	50771	2	BEARING, BALL 25.4X52X15			2	SEAL, LIP 1.000X2.049X.375
		5	PISTON, 10cc	75	50772	2	SEAL 1.000X2.049X.375			1	SEAL, LIP .875X1.375X.250
		5	SPRING, 10cc PISTON	76	50663	2	SHAFT, AXLE			2	O-RING .070X.239
		5	WASHER, PISTON SEAT	77	44130	1	WASHER			1	KIT, O-RING MANIFOLD
21	70082	1	BLOCK, 21cc CYLINDER ASSEMBLY	79	50928	1	SEALANT			8	SCREW, TORX HEAD 5/16-18
		1	BLOCK, 21cc CYLINDER	80	50868	1	SCREW, TORX HEAD .875X1.125X.75			2	WASHER .88X1.25X.04
		7	WASHER, PISTON SEAT	81	44752	1	RING, RETAINING			1	SEAL, LIP 875X1.3X.25
		7	PISTON, 21cc	82	50777	1	BRAKE DISK			1	WASHER .5X1.0X.03
		7	SPRING, 21cc PISTON	83	50775	1	WASHER .32X2.0X.14			1	SCREW, 5/16-24X1-1/2
		1	SHAFT, MOTOR	84	50773	1	SCREW, 5/16-24X1-1/2			1	BEARING .625X1.375X.433
24	50662	1	BEARING, THRUST 42X68X16	85	50779	1	SPACER, LOCATING			1	SCREW, COUNTERSUNK 5/16-18X1
25	51250	1	ARM, CONTROL	86	50132	1	NUT, HEX LOCK 5/16-24			1	NUT, HEX LOCK 5/16-24
26	51250	1	ARM, CONTROL	87	50836	1	BEARING, SLEEVE 1.0X1.31X1.34			1	BEARING, SLEEVE 1.0X1.31X1.34
27	50774	1	SPACER	88	50837	1	OIL			1	SPACER, TRUNNION
28	50661	1	GEAR, 16T PINION	89	44147	1	FITTING, O-RING ASS'Y			1	FITTING, PLASTIC HOSE
29	50975	2	CAPSCREW M6X1X25	90	51200	1	O-RING			1	O-RING
30	2000015	1	GUIDE, SLOT	92	50870	1					
31	50807	1	ARM, TRUNNION	95	50108	1					
32	2003009	1	BUSHING, TRUNNION	96	50866	1					
33	9008000-0126	1	SEAL, LIP 12X25X7	97		1					
34	51127	1	ARM, RETURN	106	50850	1					
36	50426	1	STUD 5/16-24	110	70110	1					
38	70680	1	KIT, BYPASS PLATE								
39	2003555	1	ACTUATOR, BYPASS								

Hydro-Gear
P.2 of 2. 70558-P2