

337-3000

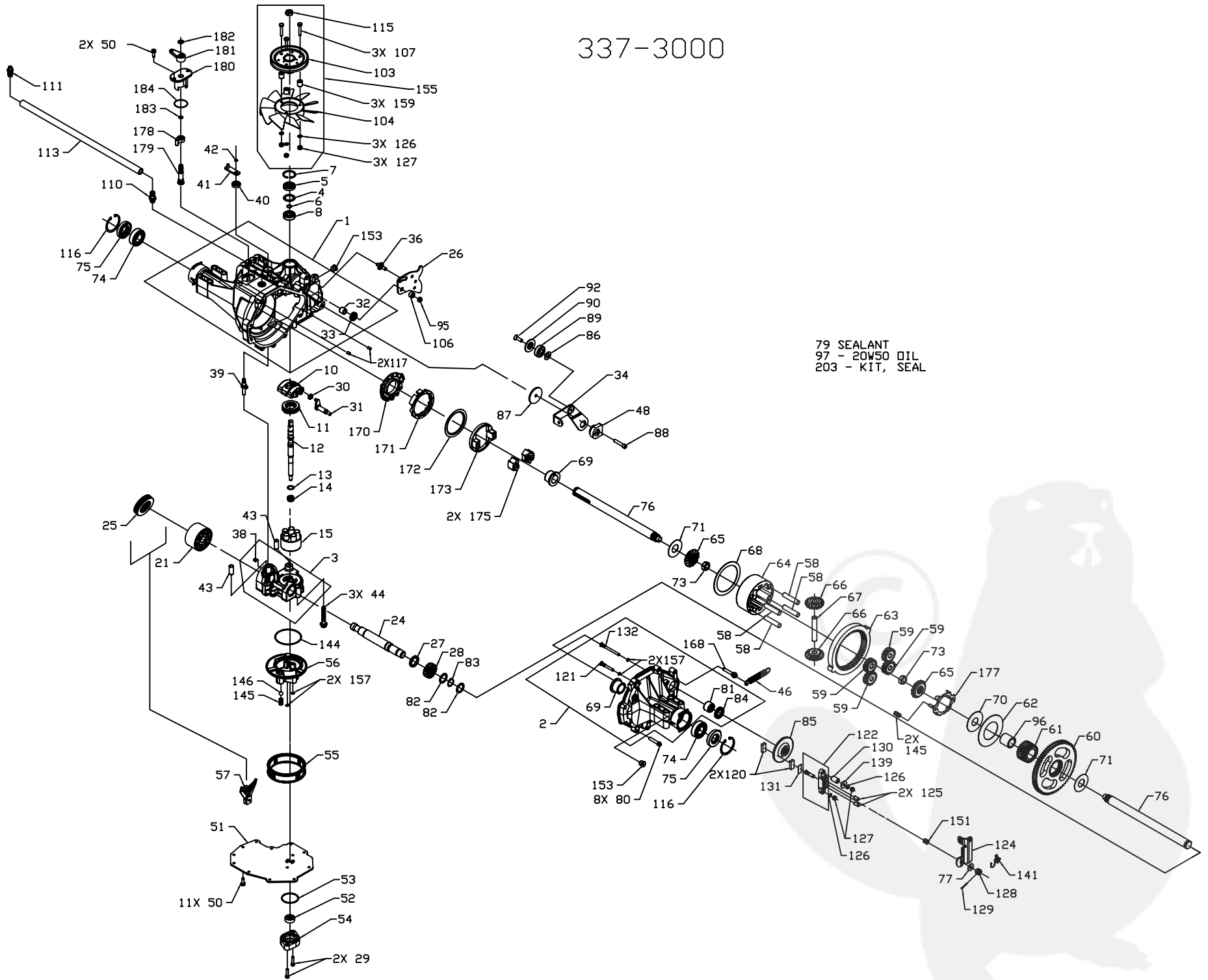

79 SEALANT
97 - 20W50 OIL
203 - KIT, SEAL

337-3000

ITEM#	PART #	QTY	DESCRIPTION
1	70876	1	MAIN HOUSING ASSEMBLY
		1	MAIN HOUSING-W/DIFF LOCK&CASE DRAIN
		1	LIP SEAL
		1	FLANGE BEARING
		1	TRUNNION BUSHING
		2	CRADLE BEARING
2	70300	1	R. H. HOUSING ASSEMBLY
		1	R. H. HOUSING
		1	FLANGE BEARING
		2	O-RING
		1	RIB NECK BOLT, 2"
		1	RIB NECK BOLT, 3"
		1	NEEDLE BEARING (SCE1412)
		1	LIP SEAL (.875 ID X 1.30 OD X .25)
3	70683	1	KIT, CENTER SECTION
		1	CENTER SECTION
		1	BUSHING .50 X .60 X .50
		1	BUSHING .90 X 1.02 X .75
		1	PLATE, BYPASS
		2	CHECK PLUG ASSEMBLY, .027
4	2003018	1	SPACER
5	9008000-0128	1	LIP, SEAL 15 X 35 X 7
6	2003016	1	RING, WIRE RETAINING
7	2003052	1	RING, RETAINING
8	2003043	1	BEARING, BALL 15 X 35 X 11
10	2003087	1	SWASHPLATE, VARIABLE
11	50551	1	BEARING, THRUST 30 X 52 X 13
12	50795	1	SHAFT, INPUT
13	2003017	1	WASHER, THRUST .591 X .787 X .040
14	2003014	1	SPRING, BLOCK
15	70331	1	BLOCK ASSEMBLY, 5 PISTON 10cc
		1	BLOCK CYLINDER, 5 PISTON 10cc
		5	PISTON
		5	SPRING, PISTON
		5	WASHER, THRUST
21	70082	1	21cc CYLINDER BLOCK ASSEMBLY
		1	21cc CYLINDER BLOCK
		7	21cc PISTON
		7	21cc PISTON SPRING
		7	PISTON SEAT WASHER
24	50662	1	SHAFT, MOTOR
25	50552	1	BEARING, THRUST 42 X 68 X 16
26	51692	1	ARM, CONTROL
27	50774	1	SPACER
28	50661	1	GEAR, 16T PINION
29	50975	2	CAPSCREW, M6 X 1-25
30	2000015	1	SLOT GUIDE
31	50807	1	ARM, TRUNNION TAPERED SQUARE
32	2003009	1	BUSHING, TRUNNION
33	9008000-0126	1	SEAL, LIP 12 X 25 X 7
34	51127	1	ARM, RETURN
36	50426	1	STUD, SHORT 5/16-24
38	70680	1	KIT, BYPASS PLATE
39	2003555	1	ACTUATOR, BYPASS
40	45074	1	SEAL, LIP 10 X 25 X 7
41	50126	1	ARM, BYPASS - 1/4-20 STUD
42	44870	1	RING, RETAINING
43	50002	2	PIN
44	50016	3	SCREW 3/8-24 X 2.5

ITEM#	PART #	QTY	DESCRIPTION
46	51199	1	SPRING, NEUTRAL
48	51097	1	PUCK, ADJUSTING
50	50752	13	SCREW, 1/4-20 X .75
51	50972	1	COVER, LOWER
52	50273	1	GEROTOR ASSEMBLY
53	9004101-1340	1	O-RING
54	50260	1	COVER, GEROTOR
55	70538	1	KIT, FILTER
		2	GASKET, .10 X .16 X .24
		1	FILTER
56	51156	1	MANIFOLD, CHARGE
57	50796	1	BEARING, MOTOR RETAINER
58	50776	4	PIN, CARRIER
59	50763	4	GEAR, 1ST PLANET
60	50646	1	GEAR, 67T SPUR
61	50645	1	GEAR, 21 TOOTH SUN
62	50769	1	PLATE, PLANET THRUST
63	50764	1	GEAR, 51T RING
64	50765	1	CARRIER, PLANETARY
65	50647	2	GEAR, BEVEL (SPLINED)
66	50648	2	GEAR, BEVEL (CROSS SHAFT)
67	50766	1	SHAFT, DIFFERENTIAL
68	50767	1	PLATE, DIFF. THRUST
69	50768	2	BEARING, FLANGE
70	51642	1	WASHER 1.0 X 2.60 X .038
71	50788	2	WASHER 1.0 X 2.25 X .04
73	50791	2	NUT, HEX JAM 5/8-18
74	50771	2	BEARING, BALL 6205-1
75	50772	2	SEAL 1 ID X 2.0472 X .375
76	50663	2	SHAFT, AXLE, 1 X 13.8 KEYED
77	44130	1	WASHER .343 X .880 X .062
79	50928	1	SEALANT
80	50868	8	SCREW, TORX HEAD 5/16-18
81	44752	1	BEARING, NEEDLE (SCE1412)
82	50777	2	WASHER .885 X 1.250 X .038
83	50775	1	RING, RETAINING
84	50773	1	SEAL, LIP .875 I.D. X 1.3 O.D. X .25
85	50779	1	DISK, BRAKE
86	50132	1	WASHER .5 X 1.0 X .03
87	50836	1	WASHER .324 X 1.960 X .146
88	50837	1	SCREW, 5/16-24 X 1-1/2
89	44147	1	BEARING
90	51200	1	SPACER, LOCATING
92	50870	1	SCREW, COUNTERSUNK 5/16-18
95	50108	1	NUT, HEX LOCK 5/16-24
96	50866	1	BEARING, SLEEVE
97		109oz	20W-50 OIL
103	50302	1	ASSEMBLY, HUB/PULLEY 4.5
104	50307	1	FAN 7.0 (10 BLADE)
106	50850	1	SPACER, TRUNNION
107	44276	3	HCSS, 1/4-20 X 1.5
110	70110	1	FITTING, O-RING ASS'Y
		1	FITTING, PLASTIC HOSE
		1	O-RING
111	70109	1	VENT, CAP ASS'Y
		1	VENT, PLASTIC
		1	VENT, CAP
113	50838	1	.50" HOSE, 20' LONG
115	44133	1	NUT, JAM 1/2-20 PATCH
116	50859	2	RING, RETAINING

ITEM#	PART #	QTY	DESCRIPTION
117	9004800-2506	2	PIN, STD HDLS
120	44132	2	PUCK, BRAKE
121	50874	1	BOLT, RIB NECK 2"
122	70633	1	YOKE, BRAKE ASSEMBLY
124	50911	1	ARM, BRAKE
125	44127	2	PINS, BRAKE
126	43177	5	LOCKWASHER, 1/4"
127	43178	5	NUT, 1/4-20
128	44142	1	NUT, CASTLE 5/16-24
129	44101	1	PIN, COTTER
130	23711	1	SPACER
131	44134	1	PUCK, PLATE
132	50865	1	BOLT, RIB NECK 3"
139	44278	1	WASHER, 7/8 OD X .265 ID X .125 THK
141	50884	1	SPRING, BRAKE ARM BIAS
144	50974	1	O-RING, 2.987 ID .103 THK
145	51157	3	SPRING, RELIEF
146	9001214-4400	1	BALL, 7/16 STEEL
151	50919	1	COMP. SPRING, BRAKE ANTI-DRAW
153	9005110-5600	2	PLUG, STRAIGHT THREAD
155	70243	1	KIT, FAN/PULLEY
		1	NUT, JAM 1/2-20
		3	WASHER, LOCK
		1	ASSEMBLY, HUB/PULLEY 4.5
		1	FAN 7.0 (10 BLADE)
		3	SCREW 1/4-20 X 1.50
		3	NUT 1/4-20
		3	SPACER
157	50977	4	O-RING, .070 X .239
159	50259	3	SPACER, .26 X .57 X .62
168	51151	1	SCREW, SHOULDERED TORX HEAD 5/16-18
170	51644	1	CAM, STATIONARY
171	51645	1	CAM, ROTATING
172	51646	1	WASHER, LIP 2.78 X 3.60 X .035
173	51647	1	PLATE, LOAD
175	51648	2	DOG, ENGAGEMENT
177	51649	1	WASHER, GUIDE
178	51650	1	CAM, ACTUATING
179	51651	1	SHAFT, ACTUATING
180	51613	1	SLEEVE
181	51652	1	HANDLE, ACTUATING
182	51628	1	RING, RETAINING .375 EXTERNAL
183	9004101-0120	1	O-RING, -012, .364 X .070
184	51654	1	O-RING, -029, 1.489 X .070
203	70492	1	KIT, SEAL
		1	SEAL-LIP 15 X 5 X 37
		1	SEAL-LIP 12 X 25 X 7
		1	SEAL-LIP 10 X 25 X 7
		1	O-RING, .103 X 1.862
		2	SEAL, LIP 1.000 X 2.049 X .375
		1	SEAL, LIP (.875 I.D. X 1.375 O.D. X .25)
		2	O-RING, .070 X .239
		1	KIT, O-RING, MANIFOLD